

Hengelau 17
78333 Stockach
Tel. +49 7771 9170160
Fax +49 7771 9170161
www.rimpel.org
info@rimpel.org

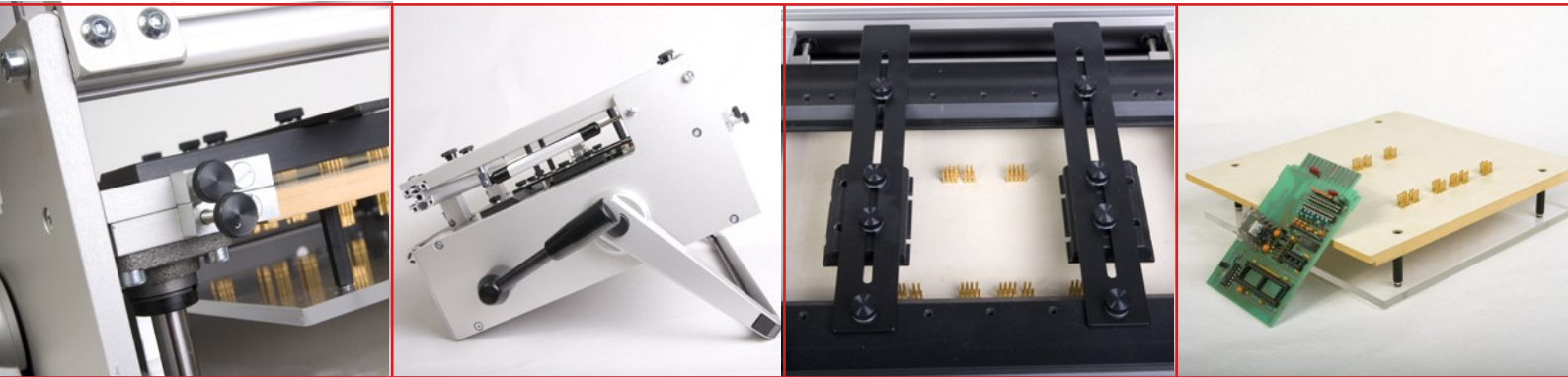

Kontakte die Zukunft sichern



Manuelle Adapter

Der manuelle Prüfadapter eignet sich durch seinen sehr stabilen Aufbau und die einfache Handhabung für Klein- und Großserien. Das Wechselblattsystem erlaubt eine kostengünstige Mehrfachnutzung des Prüfadapters. Durch Betätigen des Handhebels wird die Kontaktträgerplatte gegen die feststehende Prüflingsaufnahme gefahren. Die 4-Punkt-Synchron-Andruckmechanik gewährleistet eine gleichmäßige, leichtgängige und exakte Kontaktierung. Die Prüflingsaufnahme PAV ist stufenlos in xy-Richtung mittels Rändelschrauben einstellbar und eignet sich deshalb besonders für Kleinserien mit einer hohen Typenvielfalt.

Technische Daten

Adapter-Bezeichnung Bestell-Nr.	Nutzfläche b x t (mm)		Außenmaße b x t x h (mm)	Gewicht (kg)	Kontaktierung: Einseitig Prüfkraft: ca. 700 N Kontaktthub: 15 mm
	PAV	PAP			
ZAA-2-KUG-MANU	180 x 155	255 x 230	370 x 310 x 185	14	
ZAA-3-KUG-MANU	320 x 300	400 x 375	515 x 455 x 185	22	
ZAA-4-KUG-MANU	450 x 300	550 x 375	670 x 550 x 185	30	

PAV: Prüflings-Aufnahme-variabel stufenlos einstellbar PAP: Prüflings-Aufnahme-Platte zum Ausfräsen

Pneumatische Adapter

Durch Pneumatikzylinder wird die Kontaktträgerplatte gleichmäßig gegen die feststehende Prüflingsaufnahme gefahren. Die viersäulige Führung der Kontaktträgerplatte mit Präzisions-Kugelbuchsen garantieren eine hohe Kontaktiergenauigkeit. Das Wechselplattensystem ist passgenau und leicht zu tauschen. Der Platinenniederhalter lässt sich weit öffnen und ermöglicht so ein schnelles Bestücken des Adapters.

Technische Daten

Adapter-Bezeichnung Bestell-Nr.	MOD-2-KUG-PNEU	Kontaktierung: Einseitig Prüfkraft: ca. 1.600 N Kontaktthub: 10 mm Betriebsdruck: 4-6 Bar
	MOD-3-KUG-PNEU	
	MOD-4-KUG-PNEU	

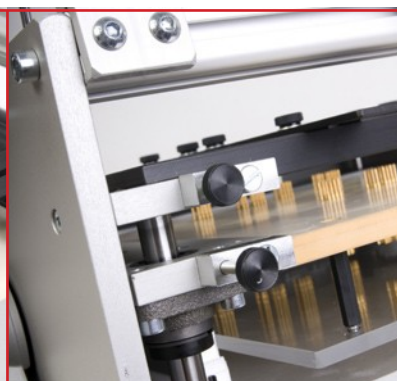
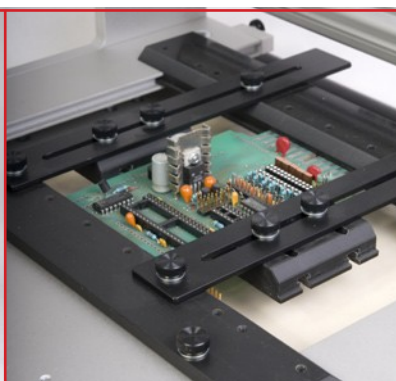

Technische Daten und allgemeine Hinweise/ Specifications and Notes

Kontaktmaterial / Oberflächen der Standard-Prüfstifte/ Material and Finish of Standard Test Probes:

Tastkopf: Plunger:	Spezialstahl gehärtet hardened special steel	- unternickelt und rhodiniert (Rh) - rhodium plated over nickel (Rh)
Gehäuse: Barrel:	Messing brass	- unternickelt und vergoldet - gold plated over nickel
Feder: Spring:	vergüteter Federstahldraht nach DIN 17223/II high quality steel wire	- unternickelt und vergoldet - gold plated over nickel
Steckhülse: Receptacle:	Messing brass	- unternickelt und vergoldet - gold plated over nickel

Federkraft:
Spring pressure:

Angaben in N, Standardkräfte siehe einzelne Bauformen (bei 80% des Federweges: zulässige Kraftabweichung nach DIN $\pm 20\%$)

Declaration of spring pressure in N, Standard pressures: see details of models (at 80% of plunger deflection. DIN-tolerance of spring pressure: $\pm 20\%$)

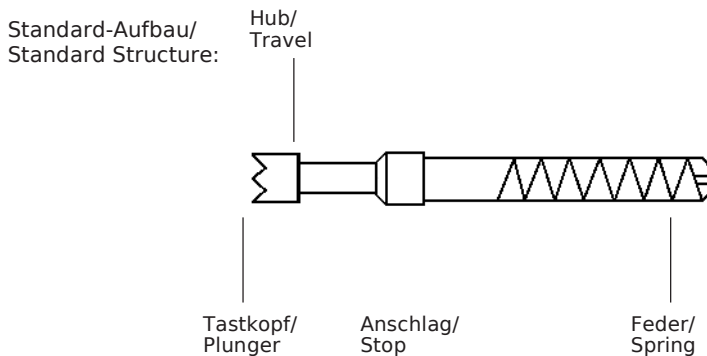

BESTELLHINWEIS / ORDERING INFORMATION

KD 2	-	01	-	08	-	1,5 N	-	Rh
------	---	----	---	----	---	-------	---	----

Bauform Model Tastkopfform Plunger Style Kopf Ø Plunger Federkraft Spring Pressure Tastkopfoberfläche Plunger Finish

Tastkopfformen - Anwendungshinweise/ Plunger Styles - Informations for Application

01		Spitze - Spear Pt. Leiterbahnen Meßinseln Miniatur- Buchsenkontakte printed leads test points mini-female contacts	07		Kegel - Convex Durchkontaktierung unbest. Leiterpl. Buchsenkontakte through plated holes of bare boards female contacts
02		rund - Sph. Rad. Lötstützpunkte Klemmstellen Schnittstellen solder terminal connect termin interfaces	08		geriffelt - serrated exzentrisch gebogene Lötanschlüsse non-axia bent component leads
03		flach - Flat druckempfindliche Kontaktflächen Schnittstellen sensitive contact areas interfaces	KD2- 11		flex. Spitze - Flexi Probe Kollophonium verschmutzte ungleichmäßige Lötstellen non-cleaned ans unshaped soldering points
04		Krone - Crown Lötanschlüsse bestückter Leiteplatten component pins of loaded boards	14		Krone mit Mittelspitze Crown with Spear Pt. kombiniert Vorzüge von 01 und 04 combines possibilities of 01 and 04
05		Innenkegel - Concave Wire-Wrap-Stifte Steckerstifte Schnittstellen wire-wrapposts male connector pins Interfaces	16		Sechskant 6 Sided Serrated Cone besonders sicher Kontaktierung unbestückter Leiterplatten high quality contact for bare boards
06		Dreikant - 3 sided chisel Drehkontakte Lötäugen unbestückte Leiterplatten rotating probes soldering holes bare boards			

MI 1

Kurzhub-Kontaktstift
Short travel test probe

KOPFFORM PLUNGER STYLE	Ø	
02	1.3	Au
03	1.3	Au
04	1.3	Au

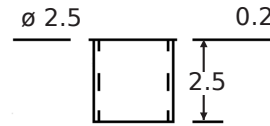
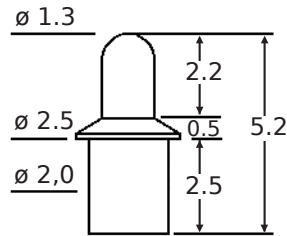

MI-25

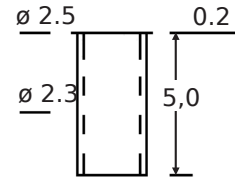

MI-50

MI-FA

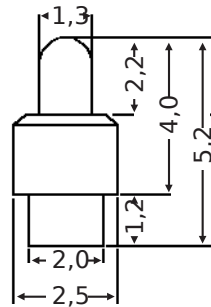

MI-SI

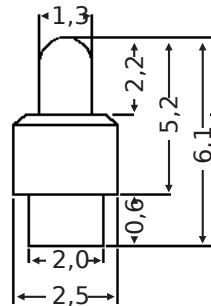

MI-SD

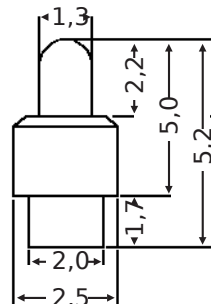

TECHNISCHE DATEN / SPECIFICATIONS

Montageabstand/
assembly distance: 3,0 mm

Montagebohrung/
assembly drill hole: 2,0 mm

MECHANISCHE DATEN / MECHANICS

Federkraft/
spring pressure: 2,0 N

Hub/
travel: 1,2 mm

Einbauhöhe/
filling height: 2,7 mm

Gesamtlänge/
length overall: 5,2 mm

ELEKTRISCHE DATEN / ELECTRICAL

Durchgangswiderstand/
internal resistance: \diamond 10 m \diamond

Nennstrom/
cont. current: 1 - 2 A

WERKSTOFF / MATERIALS

Tastkopfoberfläche:
plunger-finish: AU-vergoldet
AU goldplated

Stiftgehäuse:
pin barrel: Messing, vergoldet
brass, goldplated

Feder:
spring: Stahl, versilbert
high quality steel wire silver



BESTELLHINWEIS / ORDERING INFORMATION

MI 1	-	02	-	1,3	-	2,0 N	-	Au
------	---	----	---	-----	---	-------	---	----

Bauform Model Tastkopfform Plunger Style Kopf Ø Plunger Federkraft Spring Pressure Tastkopfoberfläche Plunger Finish

RIMPEL

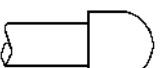
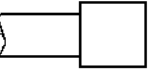
KD 08

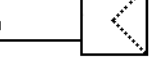
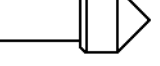
KOPFFORM PLUNGER STYLE	Ø	
01 	0.35	Rh Au
02 	0.8	Au
03 	0.8	Au
04 	0.8	Rh Au
05 	0.8	Au
07 	0.8	Au

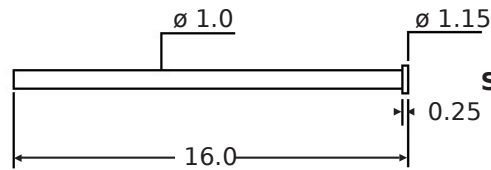
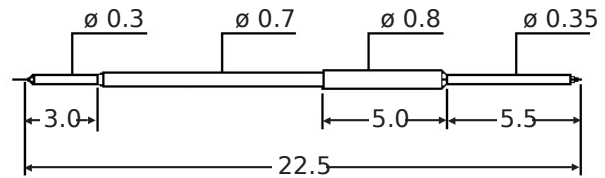

SHO-08 Lötmulde offen
solder cup open

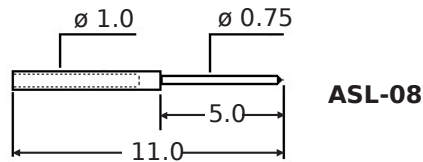

ASL-08

Einbauhöhe / filling height

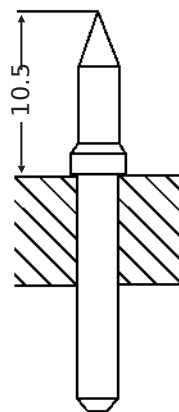

TECHNISCHE DATEN / SPECIFICATIONS

Montageabstand/
assembly distance: 1,27 mm

Montagebohrung/
assembly drill hole: 1,0 mm

MECHANISCHE DATEN / MECHANICS

Federkraft/
spring pressure: 0,8 N

Hub/
travel: 4,0 mm

Einbauhöhe/
filling height: 10,5 mm

Gesamtlänge/
length overall: 22,5 mm

ELEKTRISCHE DATEN / ELECTRICAL

Durchgangswiderstand/
internal resistance: 10 m \diamond

Nennstrom/
cont. current: 1 A

WERKSTOFF / MATERIALS

Tastkopfoberfläche:
plunger-finish: RH-rhodiniert, AU-vergoldet
RH-rhodiumplated, AU-goldplated

Stiftgehäuse:
pin barrel: Messing, vergoldet
brass, goldplated

Feder:
spring: Stahl, versilbert
high quality steel wire silver

BESTELLHINWEIS / ORDERING INFORMATION

KD 08	-	04	-	0,8	-	0,8 N	-	Au
-------	---	----	---	-----	---	-------	---	----

Bauform
Model

Tastkopfform
Plunger Style





Kopf Ø
Plunger

Federkraft
Spring Pressure

Tastkopfoberfläche
Plunger Finish

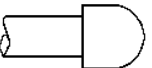
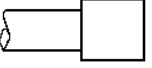
RIMPEL

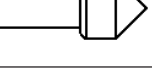
KD 1

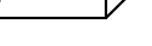
KOPFFORM PLUNGER STYLE	Ø	
01 	0.6	Rh Au
02 	1.2	Rh Au
03 	1.2	Au
04 	1.2	Rh Au
05 	1.2	Rh Au
07 	1.2	Rh Au
08 	1.2	Rh Au
17 	0.6	Rh Au

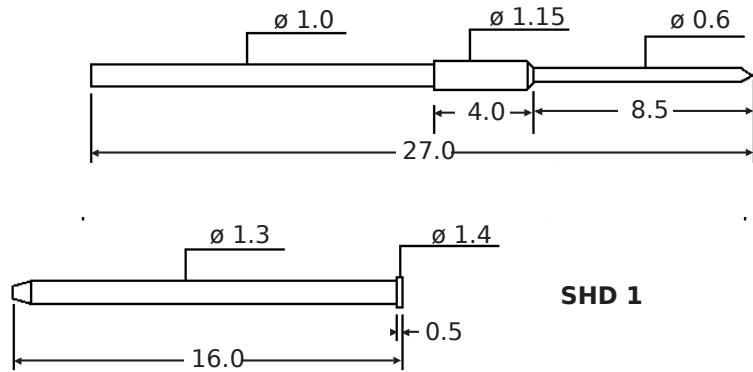

Einbauhöhe / filling height

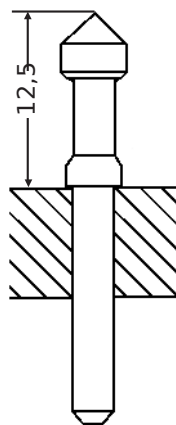

TECHNISCHE DATEN / SPECIFICATIONS

Montageabstand/
assembly distance: 2,0 mm

Montagebohrung/
assembly drill hole: 1,3 mm

MECHANISCHE DATEN / MECHANICS

Federkraft/
spring pressure: 0,8/1,5 N

Hub/
travel: 5,0 mm

Einbauhöhe/
filling height: 12,5 mm

Gesamtlänge/
length overall: 27,0 mm

ELEKTRISCHE DATEN / ELECTRICAL

Durchgangswiderstand/
internal resistance: 10 mΩ

Nennstrom/
cont. current: 1 A

WERKSTOFF / MATERIALS

Tastkopfoberfläche:
plunger-finish: RH-rhodiniert, AU-vergoldet
RH-rhodiumplated, AU-goldplated

Stiftgehäuse:
pin barrel: Messing, vergoldet
brass, goldplated

Feder:
spring: Stahl, versilbert
high quality steel wire silver

BESTELLMHINWEIS / ORDERING INFORMATION

KD 1	-	01	-	0,6	-	1,5 N	-	Rh
------	---	----	---	-----	---	-------	---	----

Bauform
Model

Tastkopfform
Plunger Style









Kopf Ø
Plunger

Federkraft
Spring Pressure

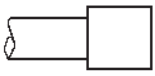
Tastkopfoberfläche
Plunger Finish

RIMPEL

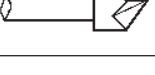
KM 1

KOPFFORM PLUNGER STYLE	Ø	
01 	0.9	Au
02 	0.9	Au
03 	1.9	Rh Au
04 	1.9	Rh Au
05 	1.9	Rh Au
07 	1.9	Rh Au
08 	1.9 3.0	Rh Au
16 	1.9	Rh Au
26 	1.9	Rh Au

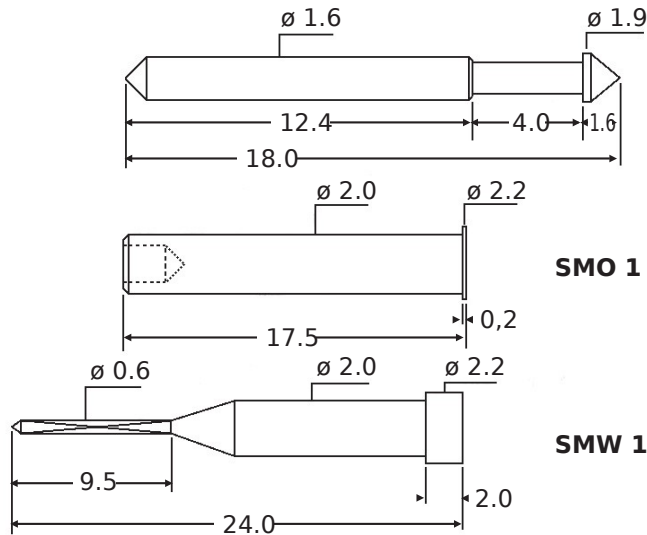

SMO 1 Lötbohrung Ø 1,5

SMW 1 wire-wrap

Einbauhöhe / filling height

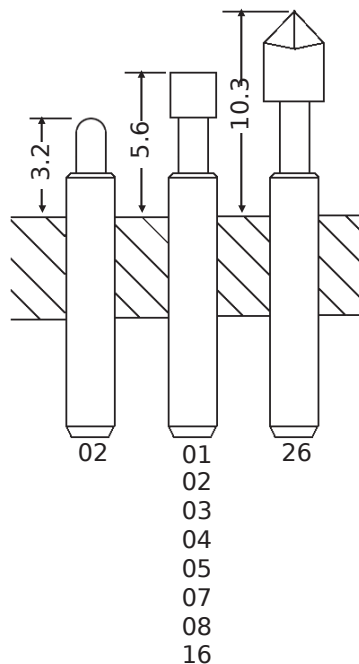

TECHNISCHE DATEN / SPECIFICATIONS

Montageabstand/
assembly distance: 2,54 mm

Montagebohrung/
assembly drill hole: 2,0 mm

MECHANISCHE DATEN / MECHANICS

Federkraft/
spring pressure: 0,8 / 1,5 / 3,0 / 4,0 N

Hub/
travel: 3,5 mm

Einbauhöhe/
filling height: 5,8 mm mit SMO 1
7,6 mm mit SMW 1

Gesamtlänge/
length overall: 18,0 mm

ELEKTRISCHE DATEN / ELECTRICAL

Durchgangswiderstand/
internal resistance: 10 mΩ

Nennstrom/
cont. current: 3 A

WERKSTOFF / MATERIALS

Tastkopfoberfläche:
plunger-finish: RH-rhodiniert, AU-vergoldet
RH-rhodiumplated, AU-goldplated

Stiftgehäuse:
pin barrel: Messing, vergoldet
brass, goldplated

Feder:
spring: Stahl, versilbert
high quality steel wire silver

BESTELLMHINWEIS / ORDERING INFORMATION

KM 1	-	04	-	1,9	-	1,5 N	-	Rh
------	---	----	---	-----	---	-------	---	----

Bauform
Model

Tastkopfform
Plunger Style





Kopf Ø
Plunger

Federkraft
Spring Pressure

Tastkopfoberfläche
Plunger Finish

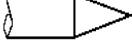
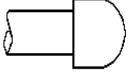
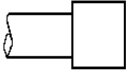
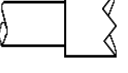
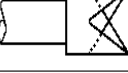
RIMPEL

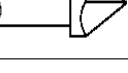
KPY 19

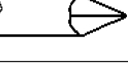
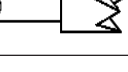
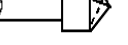
KOPFFORM PLUNGER STYLE	Ø	
01 	1.06	Au
02 	1.3	Au
03 	1.5	Au
04 	1.0 1.3 1.5	Au
04 SR 	1.5	Rh Au
05 	1.5	Au
06 	1.5	Au
08 	1.0 1.5	Au
11 	0.75	Ni
13 	1.06	Ni
14 	1.5	Au
46 	1.5	Rh

SR = selbstreinigend
self cleaning

BESTELLHINWEIS / ORDERING INFORMATION

KPY 19	-	01	-	1,06	-	1,5 N	-	Rh
--------	---	----	---	------	---	-------	---	----

Bauform Model	Tastkopfform Plunger Style	Kopf Ø Plunger	Federkraft Spring Pressure	Tastkopffoberfläche Plunger Finish
------------------	-------------------------------	-------------------	-------------------------------	---------------------------------------

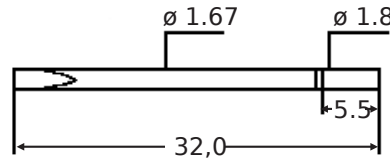
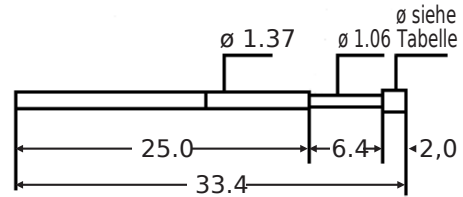

SHD 19

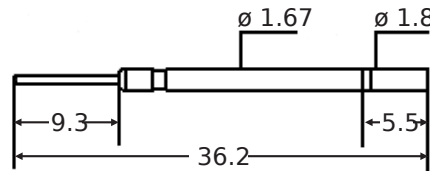

SHW 19-5,5

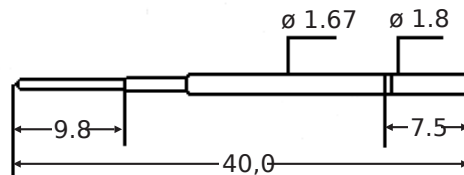

SHW 19-7,5

Einbauhöhe / filling height

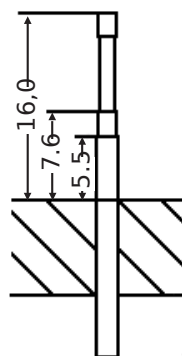

TECHNISCHE DATEN / SPECIFICATIONS

Montageabstand/
assembly distance: 2,54 mm

Montagebohrung/
assembly drill hole: 1,67 mm

MECHANISCHE DATEN / MECHANICS

Federkraft/
spring pressure: 2,0 / 3,0 N

Hub/
travel: 5,0 mm

Einbauhöhe/
filling height: 16,0 mm

Gesamtlänge/
length overall: 33,4 mm

ELEKTRISCHE DATEN / ELECTRICAL

Durchgangswiderstand/
internal resistance: 20 m Ω

Nennstrom/
cont. current: 3 A

WERKSTOFF / MATERIALS

Tastkopffoberfläche:
plunger-finish: RH-rhodiniert, AU-vergoldet
RH-rhodiumplated, AU-goldplated

Stiftgehäuse:
pin barrel: Messing, vergoldet
brass, goldplated

Feder:
spring: Stahl, versilbert
high quality steel wire silver

RIMPEL

KD 2

KOPFFORM PLUNGER STYLE	Ø	
01	0.6 0.8 1.3	Rh Au
02	2.0	Rh Au
03	2.0	Rh Au
04	1.3 1.8	Rh Au
04 SR	1.0 1.3 1.8	Rh Au
05	1.8	Rh Au
06	1.3 1.8 2.5	Rh Au
08	1.8	Rh Au
11	0.7	Au Ni
13	1.3	Ni
14	1.8	Au
15	<0.6 1.3	Au
16	1.8	Ni
21	<0.6 1.3	Rh Au

SR = selbstreinigend
self cleaning

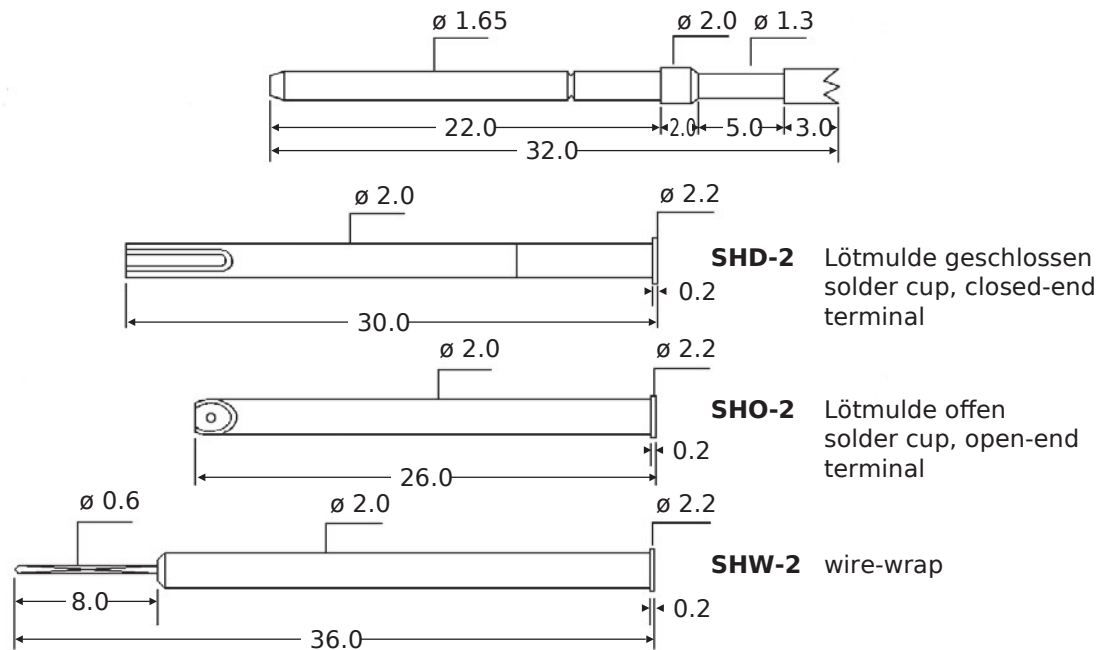

Einbauhöhe / filling height

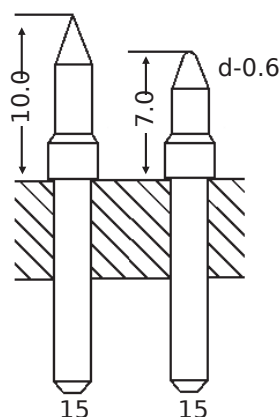

TECHNISCHE DATEN / SPECIFICATIONS

Montageabstand/
assembly distance: 2,54 mm

Montagebohrung/
assembly drill hole: 2,0 mm

MECHANISCHE DATEN / MECHANICS

Federkraft/
spring pressure: 0,8 /1,0 /1,5 /3,0 /5,0 N

Hub/
travel: 5,0 mm

Einbauhöhe/
filling height: 10,0 mm

Gesamtlänge/
length overall: 32,0 mm

ELEKTRISCHE DATEN / ELECTRICAL

Durchgangswiderstand/
internal resistance: 20 mΩ

Nennstrom/
cont. current: 3 A

WERKSTOFF / MATERIALS

Tastkopfoberfläche:
plunger-finish: RH-rhodiniert, AU-vergoldet
RH-rhodiumplated, AU-goldplated

Stiftgehäuse:
pin barrel: Messing, vergoldet
brass, goldplated

Feder:
spring: Stahl, versilbert
high quality steel wire silver







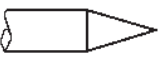

SR = selbstreinigend

BESTELLHINWEIS / ORDERING INFORMATION

KD 2	-	01	-	0,8	-	1,5 N	-	Rh
------	---	----	---	-----	---	-------	---	----

Bauform Model Tastkopfform Plunger Style Kopf Ø Plunger Federkraft Spring Pressure Tastkopfoberfläche Plunger Finish

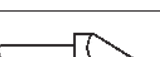
KD 2-2 KD 2-5 KD 2-7 KD 2-10

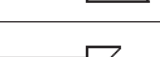
KOPFFORM PLUNGER STYLE	Ø	
01 	0.8 1.0 1.3	Rh Au
02 	1.8	Rh Au
03 	1.8	Rh Au
04 	1.3 1.8	Rh Au
04 SR 	1.3 1.8	Rh Au
05 	1.8	Rh
06 	1.8	Rh Au
08 	1.3 1.8	Rh Au
14 	1.8	Rh Au

SR = selbstreinigend
self cleaning

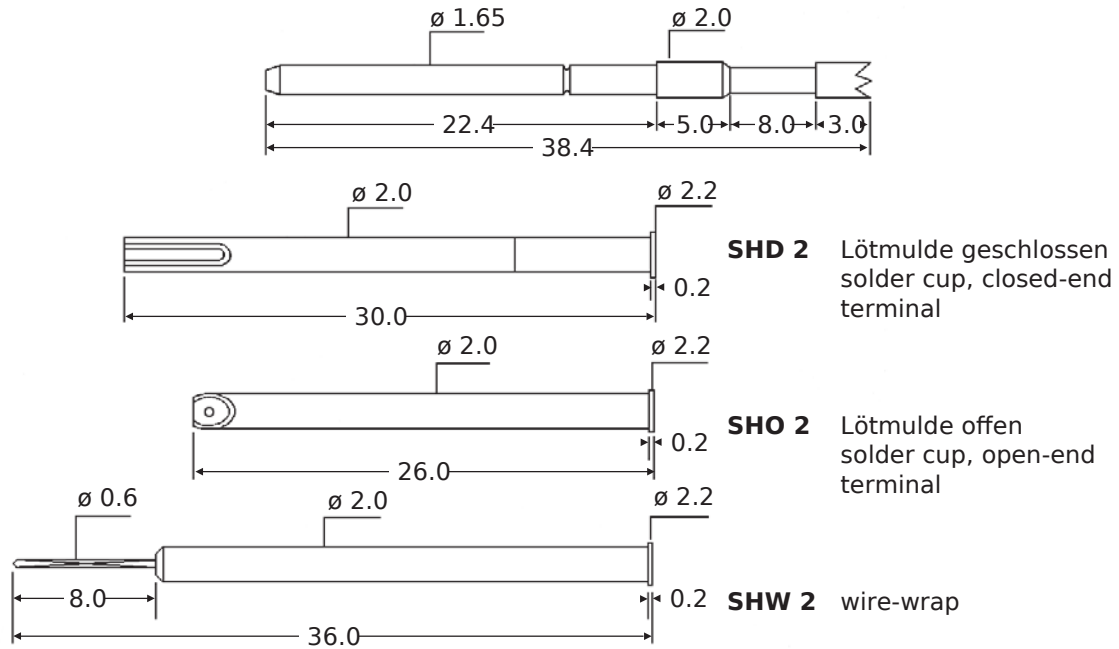

Einbauhöhe / filling height

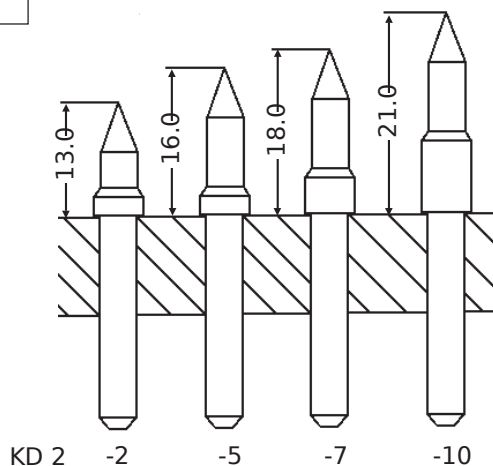

TECHNISCHE DATEN / SPECIFICATIONS

Montageabstand/
assembly distance: 2,54 mm

Montagebohrung/
assembly drill hole: 2,0 mm

MECHANISCHE DATEN / MECHANICS

Federkraft/
spring pressure: 0,8 /1,0 /1,5 /3,0 /5,0 N

Hub/
travel: 5,0-8,0 mm

Einbauhöhe/
filling height: 13,0 / 16,0 / 18,0 / 21,0 mm

Gesamtlänge/
length overall: 38,4 mm

ELEKTRISCHE DATEN / ELECTRICAL

Durchgangswiderstand/
internal resistance: 20 mΩ

Nennstrom/
cont. current: 3 A

WERKSTOFF / MATERIALS

Tastkopfoberfläche:
plunger-finish: RH-rhodiniert, AU-vergoldet
RH-rhodiumplated, AU-goldplated

Stiftgehäuse:
pin barrel: Messing, vergoldet
brass, goldplated

Feder:
spring: Stahl, versilbert
high quality steel wire silver

SR = selbstreinigend

BESTELLHINWEIS / ORDERING INFORMATION

KD 2-7	-	01	-	0,8	-	1,5 N	-	Rh
--------	---	----	---	-----	---	-------	---	----

Bauform
Model

Tastkopfform
Plunger Style





Kopf Ø
Plunger

Federkraft
Spring Pressure

Tastkopfoberfläche
Plunger Finish

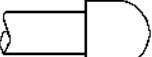
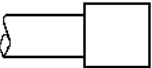
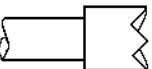
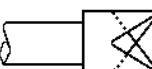
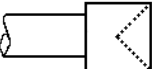
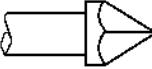
RIMPEL

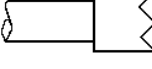
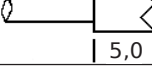
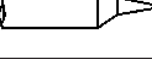
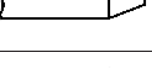
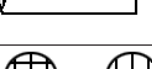
KD 3

KOPFFORM	Ø	
01 	1.8	Rh Au
02 	2.5	Rh Au
03 	2.5	Rh Au
04 	2.5 4.0	Rh Au
04 SR 	1.8 2.5	Rh Au
05 	2.5 4.0	Rh Au
06 	2.5	Rh Au
08 	1.8 2.5 4.0	Rh Au
10 	4.0	Rh Au
19 	3.5 5.0	Rh Au
21 	Ø 0.8	Rh Au
23 	1.0 1.8	Rh Au
33 	1.8	Rh Au
08  10 		

SR = selbstreinigend
self cleaning

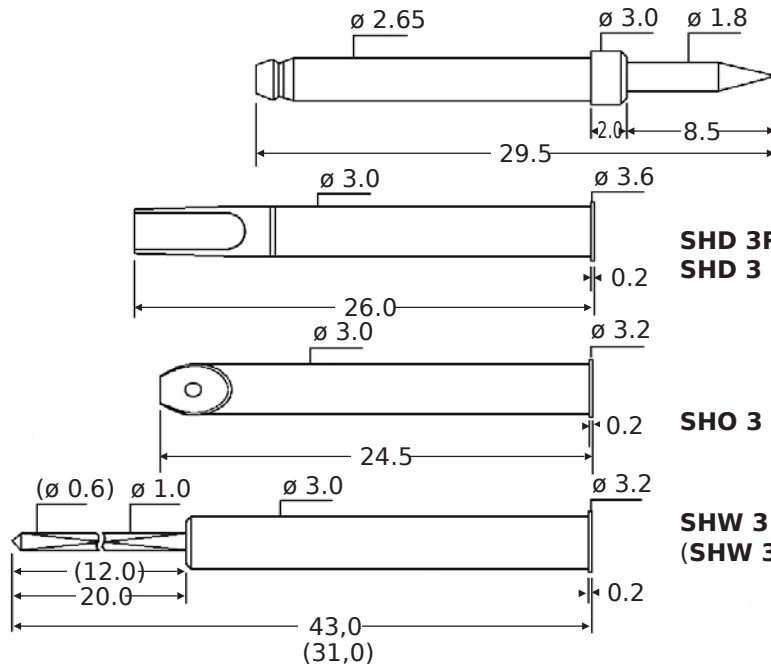

SHD 3R mit Rastrille
SHD 3 ohne Rastrille
Lötmulde geschlossen
solder cup, closed-end
terminal

SHO 3 Lötmulde offen
solder cup, open-end
terminal

SHW 3 1.0 wire-wrap
(SHW 3) 0.6 wire-wrap

Einbauhöhe / filling height

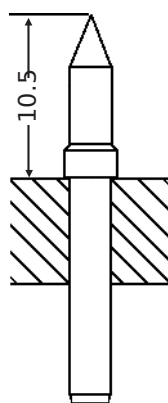

TECHNISCHE DATEN / SPECIFICATIONS

Montageabstand/
assembly distance: 4,0 mm

Montagebohrung/
assembly drill hole: 3,0 mm

MECHANISCHE DATEN / MECHANICS

Federkraft/
spring pressure: 1,0 /1,5 /3,0 /5,0 /7,0 /10,0 N

Hub/
travel: 5,0 mm

Einbauhöhe/
filling height: 10,5 mm

Gesamtlänge/
length overall: 29,5 mm

ELEKTRISCHE DATEN / ELECTRICAL

Durchgangswiderstand/
internal resistance: \blacklozenge 30 m \blacklozenge

Nennstrom/
cont. current: 4 - 5 A

WERKSTOFF / MATERIALS

Tastkopfoberfläche:
plunger-finish: RH-rhodiniert, AU-vergoldet
RH-rhodiumplated, AU-goldplated

Stiftgehäuse:
pin barrel: Messing, vergoldet
brass, goldplated

Feder:
spring: Stahl, versilbert
high quality steel wire silver

SR = selbstreinigend

BESTELLMHINWEIS / ORDERING INFORMATION

KD 3	-	01	-	1,8	-	1,0 N	-	Au
------	---	----	---	-----	---	-------	---	----

Bauform
Model

Tastkopfform
Plunger Style

Kopf Ø
Plunger

Federkraft
Spring Pressure

Tastkopfoberfläche
Plunger Finish

RIMPEL

KD 3 L

KOPFFORM PLUNGER STYLE	Ø	
11 31 41 51	1.8	Rh Au
43	2.5 4.0	Rh Au
48	2.5 4.0	Rh Au
54 64	4.0	Rh Au
55	2.5 4.0	Rh Au
23	1.0 1.8	Rh Au

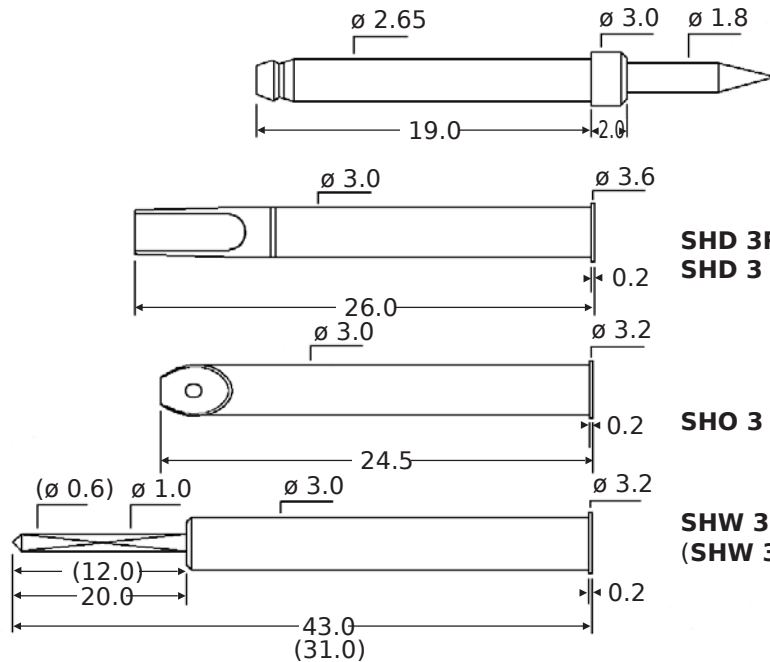

- SHD 3R** mit Rastrille
- SHD 3** ohne Rastrille
- Lötmulde geschlossen solder cup, closed-end terminal
- SHO 3** Lötmulde offen solder cup, open-end terminal
- SHW 3** 1.0 wire-wrap
- (SHW 3)** 0.6 wire-wrap

Einbauhöhe / filling height

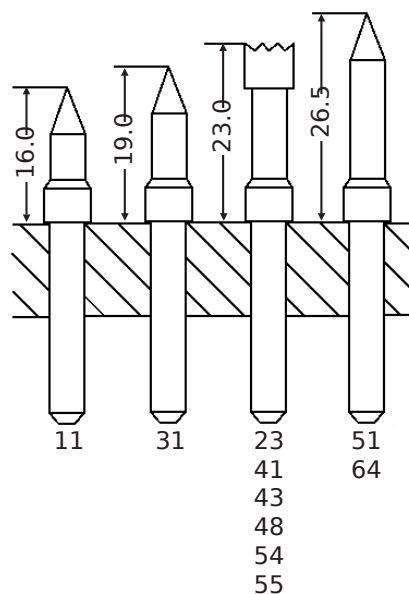

TECHNISCHE DATEN / SPECIFICATIONS

Montageabstand/
assembly distance: 4,0 mm

Montagebohrung/
assembly drill hole: 3,0 mm

MECHANISCHE DATEN / MECHANICS

Federkraft/
spring pressure: 1,0 /1,5 /3,0 /5,0 /7,0 /10,0 N

Hub/
travel: 5,0 mm

Einbauhöhe/
filling height: 16,0 /19,0 /23,0 mm

Gesamtlänge/
length overall: 35,0 /38,0 /42,0 mm

ELEKTRISCHE DATEN / ELECTRICAL

Durchgangswiderstand/
internal resistance: \blacklozenge 30 m \blacklozenge

Nennstrom/
cont. current: 4 - 5 A

WERKSTOFF / MATERIALS

Tastkopfoberfläche/
plunger-finish: RH-rhodiniert, AU-vergoldet
RH-rhodiumplated, AU-goldplated

Stiftgehäuse/
pin barrel: Messing, vergoldet
brass, goldplated

Feder/
spring: Stahl, versilbert
high quality steel wire silver

SR = selbstreinigend

BESTELLHINWEIS / ORDERING INFORMATION

KD 3 L	-	11	-	1,8	-	1,0 N	-	Rh
--------	---	----	---	-----	---	-------	---	----

Bauform Model Tastkopfform Plunger Style Kopf Ø Plunger Federkraft Spring Pressure Tastkopfoberfläche Plunger Finish

RIMPEL

KW 3

KOPFFORM PLUNGER STYLE	Ø	
01	1.8	Rh Au
02	2.5	Rh Au
03	2.5	Rh Au
04	2.5 4.0	Rh Au
04 SR	1.8 2.5	Rh Au
05	2.5 4.0	Rh Au
06	2.5	Rh Au
08	1.8 2.5 4.0	Rh Au
10	4.0	Rh Au
19	3.5 5.0	Rh Au
21	< 0.8	Rh Au
23	1.0 1.8	Rh Au
33	1.8	Rh Au
08 10		

SR = selbstreinigend
self cleaning

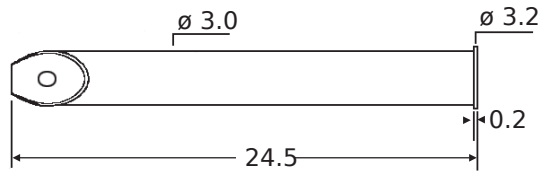
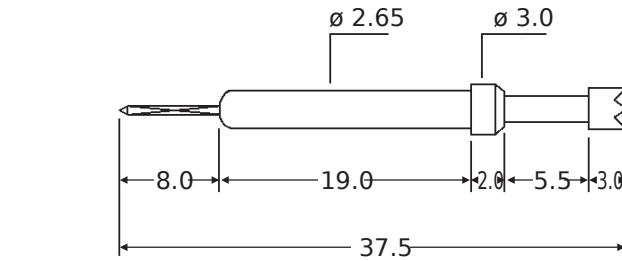

SHO 3 Lötmulde offen
solder cup, open-end
terminal

Einbauhöhe /
filling height

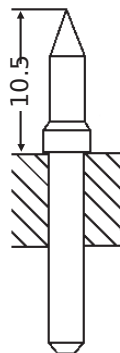

TECHNISCHE DATEN / SPECIFICATIONS

Montageabstand/
assembly distance: 4,0 mm

Montagebohrung/
assembly drill hole: 3,0 mm

MECHANISCHE DATEN / MECHANICS

Federkraft/
spring pressure: 1,0 /1,5 /3,0 /5,0 /7,0 /10,0 N

Hub/
travel: 5,0 mm

Einbauhöhe/
filling height: 10,5 mm

Gesamtlänge/
length overall: 37,5 mm

ELEKTRISCHE DATEN / ELECTRICAL

Durchgangswiderstand/
internal resistance: < 30 mΩ

Nennstrom/
cont. current: 4 - 5 A

WERKSTOFF / MATERIALS

Tastkopfoberfläche:
plunger-finish: RH-rhodiniert, AU-vergoldet
RH-rhodiumplated, AU-goldplated

Stiftgehäuse:
pin barrel: Messing, vergoldet
brass, goldplated

Feder:
spring: Stahl, versilbert
high quality steel wire silver

SR = selbstreinigend

BESTELLHINWEIS / ORDERING INFORMATION

KW 3	-	01	-	1,8	-	1,0 N	-	Au
------	---	----	---	-----	---	-------	---	----

Bauform Model Tastkopfform Plunger Style Kopf Ø Plunger Federkraft Spring Pressure Tastkopfoberfläche Plunger Finish

RIMPEL

KW 3L

KOPFFORM PLUNGER STYLE	Ø	
11 31 41 51	1.8	Rh Au
43	2.5 4.0	Rh Au
48	2.5 4.0	Rh Au
54 64	4.0	Rh Au
55	2.5 4.0	Rh Au

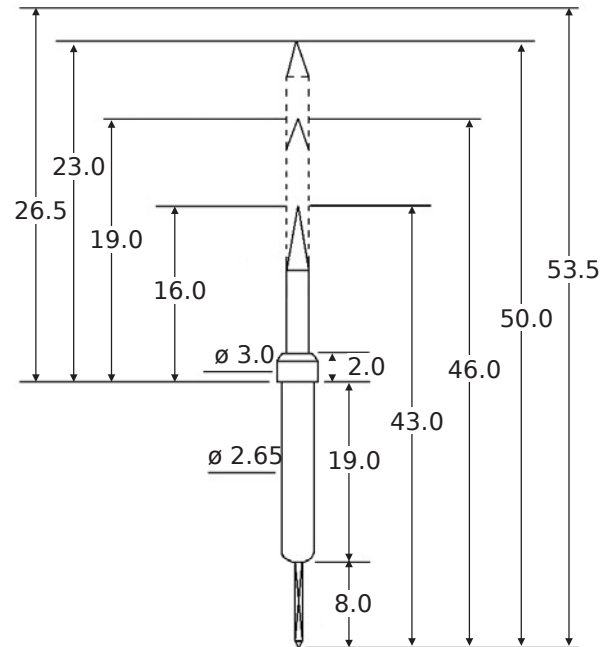

Einbauhöhe / filling height

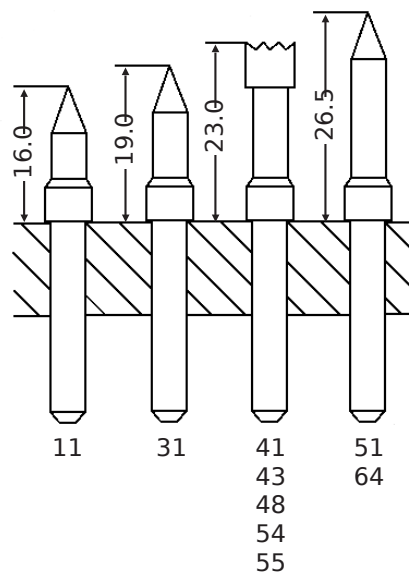

TECHNISCHE DATEN / SPECIFICATIONS

Montageabstand/
assembly distance: 4,0 mm

Montagebohrung/
assembly drill hole: 3,0 mm

MECHANISCHE DATEN / MECHANICS

Federkraft/
spring pressure: 1,0 /1,5 /3,0 /5,0 /7,0 /10,0 N

Hub/
travel: 5,0 mm

Einbauhöhe/
filling height: 16,0 /19,0 /23,0 /26,5 mm

Gesamtlänge/
length overall: 43,0 /46,0 /50,0 /53,0 mm

ELEKTRISCHE DATEN / ELECTRICAL

Durchgangswiderstand/
internal resistance: $\diamond 30 \text{ m}\Omega$

Nennstrom/
cont. current: 4 - 5 A

WERKSTOFF / MATERIALS

Tastkopfoberfläche:
plunger-finish: RH-rhodiniert, AU-vergoldet
RH-rhodiumplated, AU-goldplated

Stiftgehäuse:
pin barrel: Messing, vergoldet
brass, goldplated

Feder:
spring: Stahl, versilbert
high quality steel wire silver

SR = selbstreinigend

BESTELLMHINWEIS / ORDERING INFORMATION

KW 3 L	-	11	-	1,8	-	1,0 N	-	Rh
--------	---	----	---	-----	---	-------	---	----

Bauform
Model

Tastkopfform
Plunger Style

Kopf Ø
Plunger

Federkraft
Spring Pressure

Tastkopfoberfläche
Plunger Finish

RIMPEL

KD 33

KOPFFORM PLUNGER STYLE	Ø	
11 31 41 51	1.8	Rh Au
23	1.0 1.8	Rh Au
43	2.5 4.0	Rh Au
48	2.5 4.0	Rh Au
54	4.0	Au
64	4.0	Rh
55	2.5 4.0	Rh Au

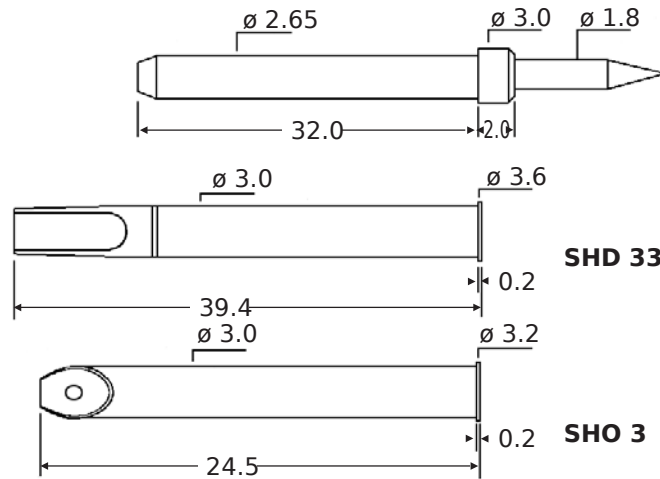

SHD 33 Lötmulde geschlossen
solder cup, closed-end
terminal

SHO 3 Lötmulde offen
solder cup, open-end
terminal

Variable Einbauhöhe /
flexible filling height
16.0 - 26.5 mm

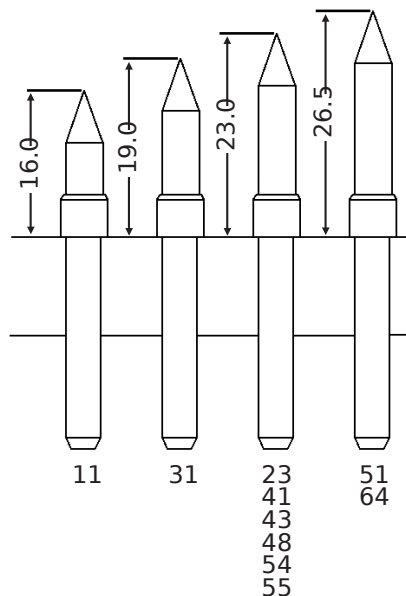

TECHNISCHE DATEN / SPECIFICATIONS

Montageabstand/
assembly distance: 4,0 mm

Montagebohrung/
assembly drill hole: 3,0 mm

MECHANISCHE DATEN / MECHANICS

Federkraft/
spring pressure: 1,5 /3,0 /5,0 /10,0 N

Hub/
travel: 10,5 - 19,0 mm

Einbauhöhe/
filling height: 16,0 - 27,0 mm

Gesamtlänge/
length overall:

ELEKTRISCHE DATEN / ELECTRICAL

Durchgangswiderstand/
internal resistance: 30 mΩ

Nennstrom/
cont. current: 4 - 5 A

WERKSTOFF / MATERIALS

Tastkopfoberfläche:
plunger-finish: RH-rhodiniert, AU-vergoldet
RH-rhodiumplated, AU-goldplated

Stiftgehäuse:
pin barrel: Messing, vergoldet
brass, goldplated

Feder:
spring: Stahl, versilbert
high quality steel wire silver

SR = selbstreinigend

BESTELLHINWEIS / ORDERING INFORMATION

KD 33	-	11	-	1,8	-	1,5 N	-	Rh
-------	---	----	---	-----	---	-------	---	----

Bauform
Model

Tastkopfform
Plunger Style







Kopf Ø
Plunger

Federkraft
Spring Pressure

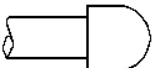
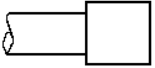
Tastkopfoberfläche
Plunger Finish

KDS 3

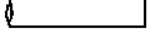
Schaltkontaktstift

KOPFFORM PLUNGER STYLE	Ø	
01 	1.8	Au
02 	2.5	Au
03 	2.5	Au
05 	2.5	Au
06 	2.5	Au
08 	2.5	Au
13 	1.8	Au
15 	3.0	K

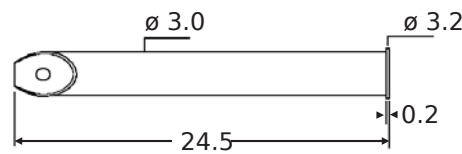
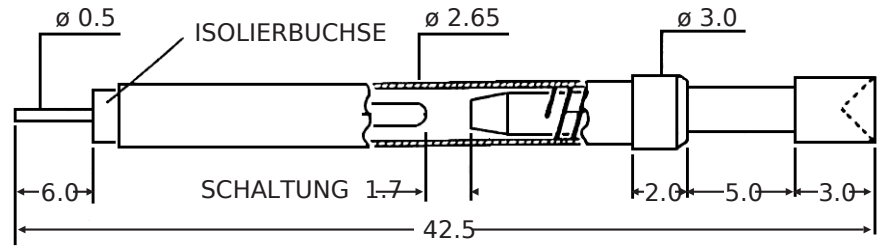

SHO 3 Lötmulde offen
solder cup, open-end
terminal

Einbauhöhe / filling height

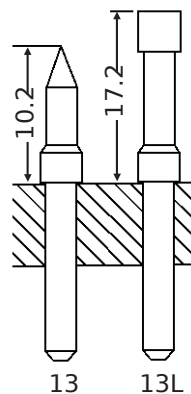

TECHNISCHE DATEN / SPECIFICATIONS

Montageabstand/
assembly distance: 4,5 mm

Montagebohrung/
assembly drill hole: 3,0 mm

MECHANISCHE DATEN / MECHANICS

Federkraft/
spring pressure: 2,0 N

Hub/
travel: 5,0 mm

Einbauhöhe/
filling height: 10,2 mm mit/with SHO-3

Gesamtlänge/
length overall: 42,5 mm

ELEKTRISCHE DATEN / ELECTRICAL

Durchgangswiderstand/
internal resistance: \blacklozenge 10 m \blacklozenge

Nennstrom/
cont. current: 1 A

WERKSTOFF / MATERIALS

Tastkopfoberfläche:
plunger-finish: AU-vergoldet
AU-goldplated

Stiftgehäuse:
pin barrel: Messing, vergoldet
brass, goldplated

Feder:
spring: Stahl, versilbert
high quality steel wire silver

K = Kunststoff

BESTELLMHINWEIS / ORDERING INFORMATION

KDS 3	-	01	-	1,8	-	2,0 N	-	Au
-------	---	----	---	-----	---	-------	---	----

Bauform
Model

Tastkopfform
Plunger Style

Kopf Ø
Plunger

Federkraft
Spring Pressure

Tastkopfoberfläche
Plunger Finish

RIMPEL

DSKD 2

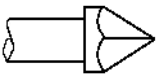
KOPFFORM PLUNGER STYLE	Ø	
06 	1.3 2.0	Rh

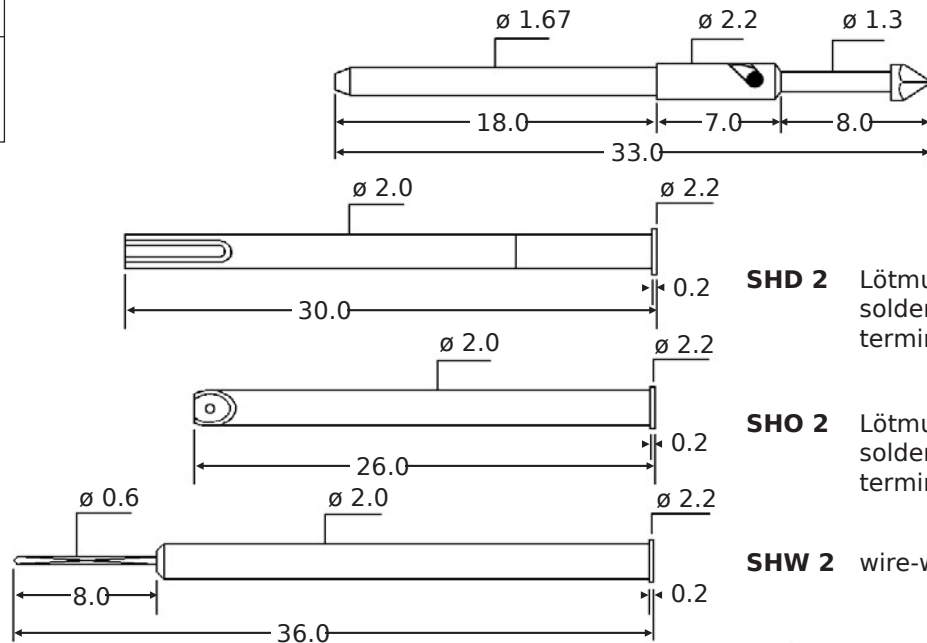

SHD 2 Lötmulde geschlossen
solder cup, closed-end
terminal

SHO 2 Lötmulde offen
solder cup, open-end
terminal

SHW 2 wire-wrap

Einbauhöhe / filling height

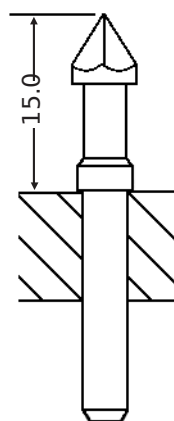

TECHNISCHE DATEN / SPECIFICATIONS

Montageabstand/
assembly distance: 2,54 mm

Montagebohrung/
assembly drill hole: 2,0 mm

MECHANISCHE DATEN / MECHANICS

Federkraft/
spring pressure: 1,5 /3,0 /5,0 N

Hub/
travel: 5,0 mm

Einbauhöhe/
filling height: 15,0 mm

Gesamtlänge/
length overall: 33,0 mm

ELEKTRISCHE DATEN / ELECTRICAL

Durchgangswiderstand/
internal resistance: 10 mΩ

Nennstrom/
cont. current: 5 A

WERKSTOFF / MATERIALS

Tastkopfoberfläche:
plunger-finish: RH-rhodiniert,
RH-rhodiumplated

Stiftgehäuse:
pin barrel: Messing, vergoldet
brass, goldplated

Feder:
spring: Stahl, versilbert
high quality steel wire silver

BESTELLHINWEIS / ORDERING INFORMATION

DSKD 2	-	06	-	1,3	-	1,5 N	-	Rh
--------	---	----	---	-----	---	-------	---	----

Bauform Model	Tastkopfform Plunger Style	Kopf Ø Plunger	Federkraft Spring Pressure	Tastkopfoberfläche Plunger Finish
------------------	-------------------------------	-------------------	-------------------------------	--------------------------------------

RIMPEL

DSKD 3

KOPFFORM PLUNGER STYLE	Ø	
06	2.2	Rh

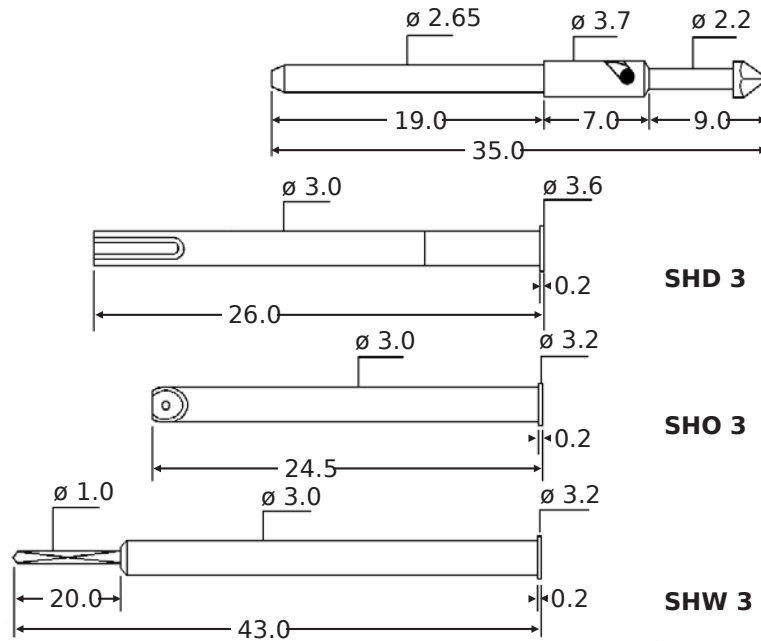

SHD 3 Lötmulde geschlossen
solder cup, closed-end
terminal

SHO 3 Lötmulde offen
solder cup, open-end
terminal

SHW 3 wire-wrap

Einbauhöhe / filling height

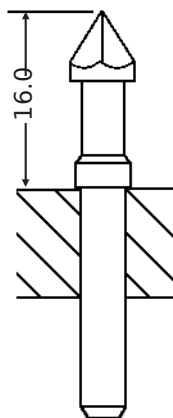

TECHNISCHE DATEN / SPECIFICATIONS

Montageabstand/
assembly distance: 4,0 mm

Montagebohrung/
assembly drill hole: 3,0 mm

MECHANISCHE DATEN / MECHANICS

Federkraft/
spring pressure: 1,5 /3,0 /5,0 N

Hub/
travel: 5,0 mm

Einbauhöhe/
filling height: 16,0 mm

Gesamtlänge/
length overall: 35,0 mm

ELEKTRISCHE DATEN / ELECTRICAL

Durchgangswiderstand/
internal resistance: 30 mΩ

Nennstrom/
cont. current: 5 A

WERKSTOFF / MATERIALS

Tastkopfoberfläche:
plunger-finish: RH-rhodiniert
RH-rhodiumplated

Stiftgehäuse:
pin barrel: Messing, vergoldet
brass, goldplated

Feder:
spring: Stahl, versilbert
high quality steel wire silver



BESTELLHINWEIS / ORDERING INFORMATION

DSKD 3	-	06	-	2,2	-	1,5 N	-	Rh
--------	---	----	---	-----	---	-------	---	----

Bauform Model	Tastkopfform Plunger Style	Kopf Ø Plunger	Federkraft Spring Pressure	Tastkopfoberfläche Plunger Finish
------------------	-------------------------------	-------------------	-------------------------------	--------------------------------------

NDA 3

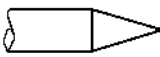
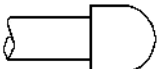
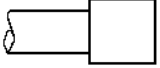
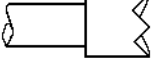
Kontaktstift mit durchgehendem Tastkopf
Test probe with continuous plunger

KOPFFORM PLUNGER STYLE	Ø	
01 	2.1	Rh
02 	3.5	Rh
03 	3.5	Rh
04 	3.5	Rh
05 	3.5	Rh

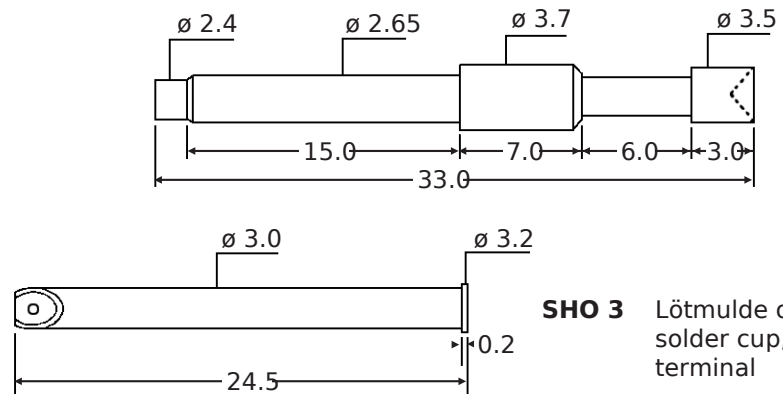

SHO 3 Lötmulde offen
solder cup, open-end
terminal

Einbauhöhe / filling height

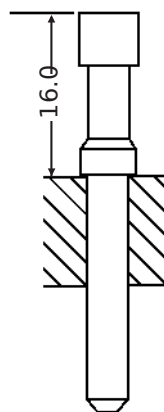

TECHNISCHE DATEN / SPECIFICATIONS

Montageabstand/
assembly distance: 4,0 mm
 Montagebohrung/
assembly drill hole: 3,0 mm

MECHANISCHE DATEN / MECHANICS

Federkraft/
spring pressure: 1,5 /3,0 /5,0 N
 Hub/
travel: 6,0 mm
 Einbauhöhe/
filling height: 16,0 mm
 Gesamtlänge/
length overall: 33,0 mm

ELEKTRISCHE DATEN / ELECTRICAL

Durchgangswiderstand/
internal resistance: \blacklozenge 30 m \blacklozenge
 Nennstrom/
cont. current: 10 A

WERKSTOFF / MATERIALS

Tastkopfoberfläche:
plunger-finish: RH-rhodiniert
RH-rhodiumplated
 Stiftgehäuse:
pin barrel: Messing, vergoldet
brass, goldplated
 Feder:
spring: Stahl, versilbert
high quality steel wire silver

BESTELLHINWEIS / ORDERING INFORMATION

NDA 3	-	03	-	3,5	-	1,5 N	-	Rh
-------	---	----	---	-----	---	-------	---	----

Bauform Model Tastkopfform Plunger Style Kopf Ø Plunger Federkraft Spring Pressure Tastkopfoberfläche Plunger Finish

NDS 3

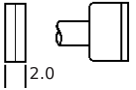
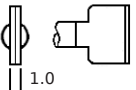
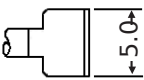
KOPFFORM PLUNGER STYLE	Ø	
	2.0	Rh
	1.0	Rh
	5.0	

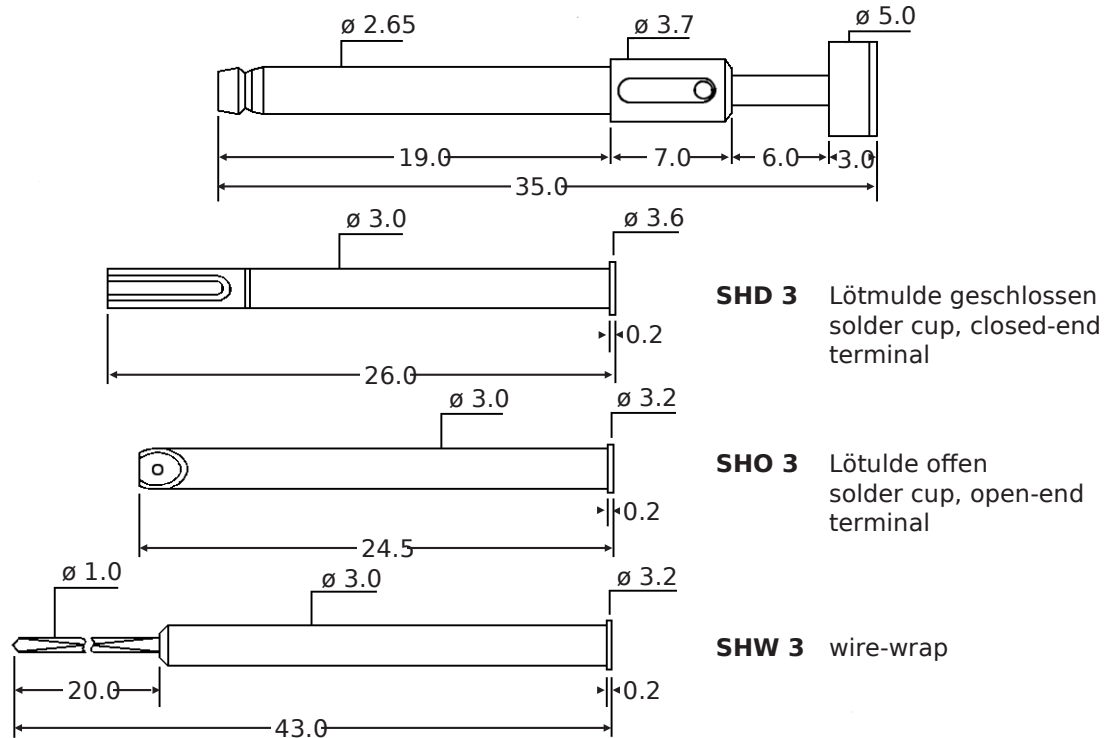

Einbauhöhe / filling height

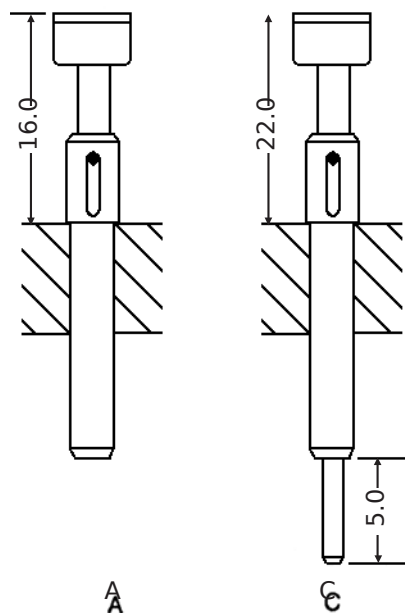

TECHNISCHE DATEN / SPECIFICATIONS

Montageabstand/
assembly distance: 4,0 - 7,0 mm

Montagebohrung/
assembly drill hole: 3,0 mm

MECHANISCHE DATEN / MECHANICS

Federkraft/
spring pressure: 1,5 / 3,0 N

Hub/
travel: 5,0 mm

Einbauhöhe/
filling height: 16,0 mm

Gesamtlänge/
length overall: 35,0 mm

ELEKTRISCHE DATEN / ELECTRICAL

Durchgangswiderstand/
internal resistance: 30 mΩ

Nennstrom/
cont. current: 5 A

WERKSTOFF / MATERIALS

Tastkopfoberfläche:
plunger-finish: RH-rhodiniert
RH-rhodiumplated

Stiftgehäuse:
pin barrel: Messing, vergoldet
brass, goldplated

Feder:
spring: Stahl, versilbert
high quality steel wire silver

BESTELLHINWEIS / ORDERING INFORMATION

NDS 3	-	A-1,0	-	5,0	-	3,0 N	-	Rh
-------	---	-------	---	-----	---	-------	---	----

Bauform Model Tastkopfform Plunger Style Kopf Ø Plunger Federkraft Spring Pressure Tastkopfoberfläche Plunger Finish

MI 17

Kurzhub-Kontaktstift
Short travel test probe

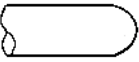
KOPFFORM PLUNGER STYLE	Ø	
02 	1.3	Au

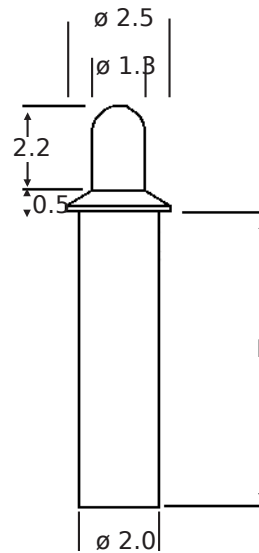

TECHNISCHE DATEN / SPECIFICATIONS

Montageabstand/
assembly distance: 3,0 mm

Montagebohrung/
assembly drill hole: 2,0 mm

MECHANISCHE DATEN / MECHANICS

Federkraft/
spring pressure: 0,8 / 1,5 / 3,0 / 4,0 N

Hub/
travel: 1,2 mm

Einbauhöhe/
filling height: 2,7 mm

Gesamtlänge/
length overall: 9,7 / 17,7 mm

ELEKTRISCHE DATEN / ELECTRICAL

Durchgangswiderstand/
internal resistance: \diamond 10 m \diamond

Nennstrom/
cont. current: 1 - 2 A

WERKSTOFF / MATERIALS

Tastkopfoberfläche:
plunger-finish: AU-vergoldet
AU goldplated

Stiftgehäuse:
pin barrel: Messing, vergoldet
brass, goldplated

Feder:
spring: Stahl, versilbert
high quality steel wire silver

BESTELLMHINWEIS / ORDERING INFORMATION



MI 17	-	02	-	1,3	-	3,0 N	-	Au	$L = 15$ mm
									$L = 7$ mm

Bauform Model	Tastkopfform Plunger Style	Kopf Ø Plunger	Federkraft Spring Pressure	Tastkopfoberfläche Plunger Finish
------------------	-------------------------------	-------------------	-------------------------------	--------------------------------------

RIMPEL

KSOF 3

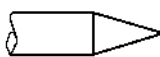
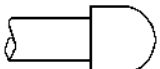
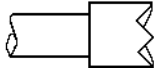
Kontaktstift mit durchgehendem Tastkopf
Test probe with continuous plunger

KOPFFORM PLUNGER STYLE	Ø	
01 	3.0	Rh Au
02 	3.0	Rh Au
04 	3.0	Rh Au
08 	4.0	Rh Au

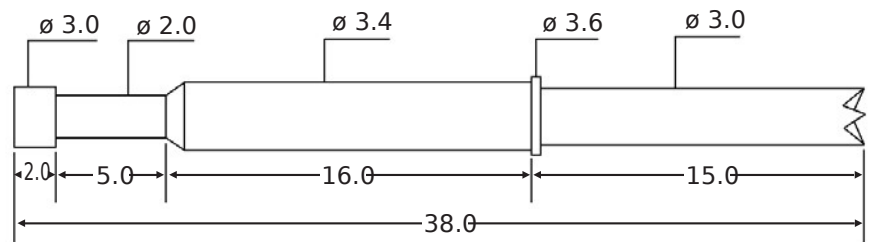

Verwendbar ohne Steckhülse
usable without receptacle

Einbauhöhe / filling height

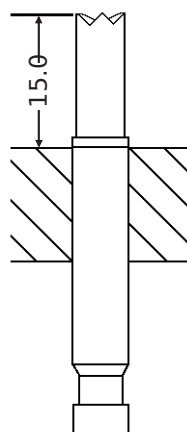

TECHNISCHE DATEN / SPECIFICATIONS

Montageabstand/
assembly distance: 4,0 mm

Montagebohrung/
assembly drill hole: 3,4 mm

MECHANISCHE DATEN / MECHANICS

Federkraft/
spring pressure: 1,5 /3,0 /5,0 N

Hub/
travel: 6,0 mm

Einbauhöhe/
filling height: 15,0 mm

Gesamtlänge/
length overall: 38,0 mm

ELEKTRISCHE DATEN / ELECTRICAL

Durchgangswiderstand/
internal resistance: $\diamond 30 \text{ m}\diamond$

Nennstrom/
cont. current: 10 A

WERKSTOFF / MATERIALS

Tastkopfoberfläche:
plunger-finish: RH-rhodiniert
RH-rhodiumplated

Stiftgehäuse:
pin barrel: Messing, vergoldet
brass, goldplated

Feder:
spring: Stahl, versilbert
high quality steel wire silver

BESTELLHINWEIS / ORDERING INFORMATION

KSOF 3	-	01	-	3,0	-	1,5 N	-	Rh
--------	---	----	---	-----	---	-------	---	----

Bauform Model Tastkopfform Plunger Style Kopf Ø Plunger Federkraft Spring Pressure Tastkopfoberfläche Plunger Finish

KK 5

KK 5-02-S

Kontaktstift mit durchgehendem Tastkopf
Test probe with continuous plunger

KOPFFORM PLUNGER STYLE	Ø	
02 02-S	4.0	Ni
03	4.0	Ni
04	4.0	Ni
08	4.0 5.0 6.0	Ni
22	4.0	Ni
13	3.0	Ni
23	1.5	Ni
18	3.0	Ni

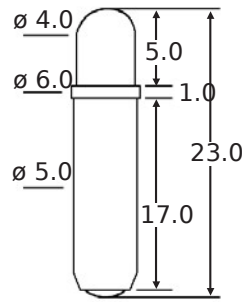

KK 5

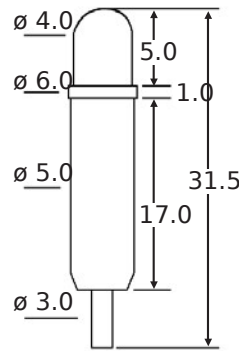

KK 5-02-S

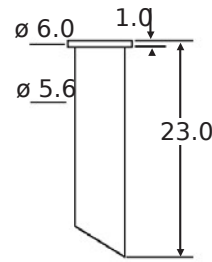

SHO 5

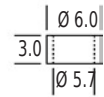

DS 1.5
DS 3

ELEKTRISCHE DATEN / ELECTRICAL

Durchgangswiderstand/
internal resistance: \blacklozenge 30 m \blacklozenge
 Nennstrom/
cont. current: 10 A

Einbauhöhe / filling height

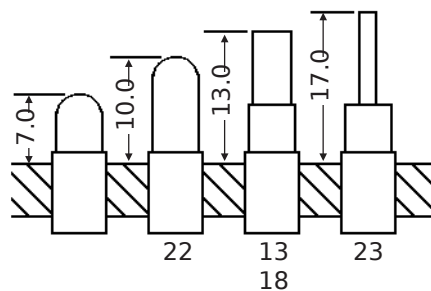

TECHNISCHE DATEN / SPECIFICATIONS

Montageabstand/
assembly distance: 6,5 mm
 Montagebohrung/
assembly drill hole: 5,6 mm

MECHANISCHE DATEN / MECHANICS

Federkraft/
spring pressure: 1,5 /3,0 /5,0 N
 Hub/
travel: 5,0 mm
 Einbauhöhe/
filling height: 7,0 /10,0 /13,0 /17,0 mm
 Gesamtlänge/
length overall: 23,0 mm

ELEKTRISCHE DATEN / ELECTRICAL

Durchgangswiderstand/
internal resistance: \blacklozenge 30 m \blacklozenge
 Nennstrom/
cont. current: 8 A

WERKSTOFF / MATERIALS

Tastkopfoberfläche:
plunger-finish: Ni vernickelt
NI nickelplated
 Stiftgehäuse:
pin barrel: Messing
brass
 Feder:
spring: Stahl
high quality steel

BESTELLHINWEIS / ORDERING INFORMATION

KK 5	-	02	-	4,0	-	1,5 N	-	Ni
------	---	----	---	-----	---	-------	---	----

Bauform Model Tastkopfform Plunger Style Kopf Ø Plunger Federkraft Spring Pressure Tastkopfoberfläche Plunger Finish

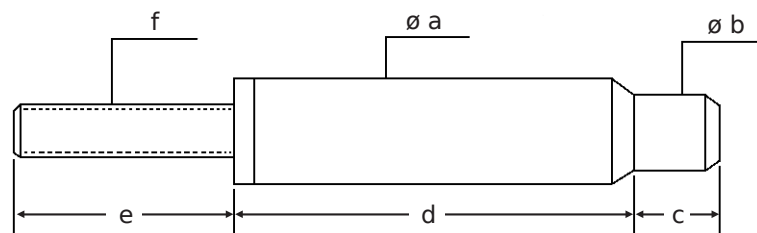

BESTELL-NUMMER	a Ø	b Ø	c HUB	d	e	f GEWINDE	STROM STÄRKE	ANFANGS- FEDERKRAFT	FEDERKRAFT NACH 7 mm HUB	SILBER- AUFLAGE mm
HSK 25	9	5.9	9	28.5	20	M 5	25 A	0.5 kp	1.0 kp	1.0
HSK 35	13	9.9	11	42	27	M 6	35 A	0.62 kp	1.2 kp	1.0
HSK 150	16	14	12	42	27	M 6	150 A	0.7 kp	1.45 kp	1.0
HSK 200	26	19.9	11	52	27	M 8	200 A	3.9 kp	5.95 kp	1.0
HSK 400	32	25.9	12	50	50	M 12	400 A	6.97 kp	11.6 kp	3 x Ø 8 x 1.5

BESTELNHINWEIS / ORDERING INFORMATION

HSK 25

Bauform
Model

DR 2-2

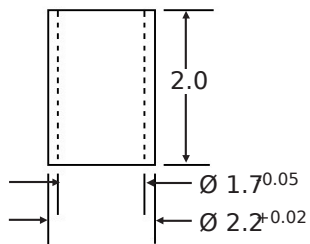

DR 2-3

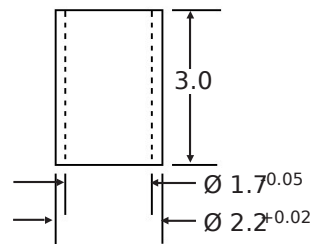

DR 3-1

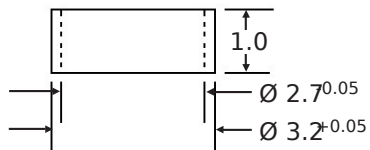

DR 3-1.5

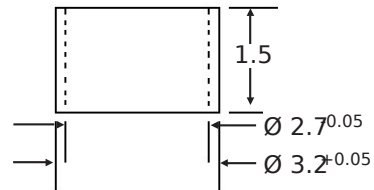

DR 3-2

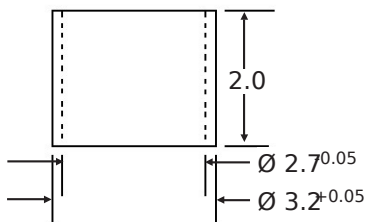

DR 3-3

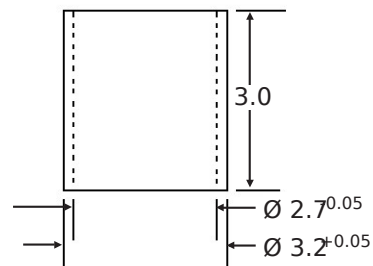

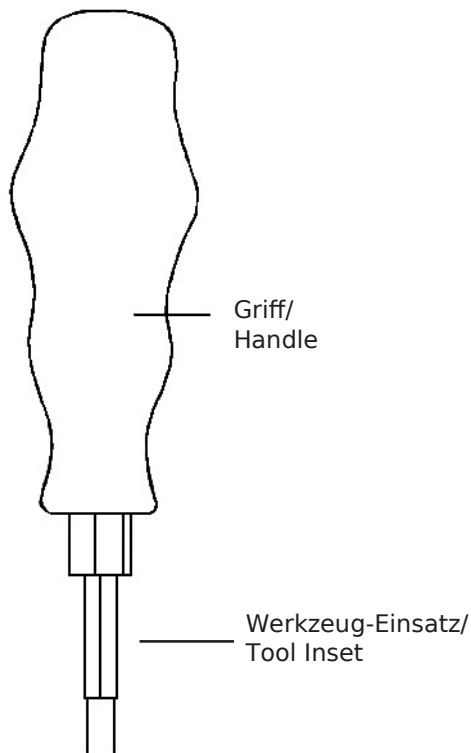

Durch das Setzwerkzeug ist ein Beschädigen des Stiftes beim Einsetzen in die vorgesehene Aufnahmebohrung im Kontaktfeld des Prüfadapters ausgeschlossen.
Bei einigen Baureihen kann das Setzwerkzeug auch als Ziehwerkzeug verwendet werden.

Werkzeugtyp Tool Type	Setzen To Insert	Ziehen To Extract
SZW 8	SHO 08	KD 08
SZW 19	SHD 1, SPY 19	KD 1, KPY 19
SZW 20	SHD 2, SHO 2, SHW 2 SMO 1, SMW 1	KD 2, KM 1, KL 2, KW 2
SZW 20 R	SHD 2, SHO 2, SHW 2	KR 2
SZW 30	SHD 3, SHO 3, SHW 3	KD 3, KD 33, KW 3
SZW 50	SHO 5	-